

AXO • PE

Raccordo per tubi PE con guarnizione tronco-conica
Fitting for PE-pipe with tapered gasket

Art. H.0300 AXO•PE

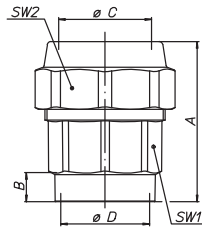

Raccordo diritto femmina per tubi in polietilene, sabbato.
Straight fitting for PE-pipe, female, sandblasted.

SIZE	½"x20	¾"x25	1"x32	1¼"x40	1½"x50	2"x63		½"x25	¾"x32	1"x40
A mm	44	51,8	59	66,5	76,5	89		50,3	57,2	65,5
B mm	9,7	11,2	12,7	13,7	15,7	17,7		9,7	11,2	12,7
øC mm	20	25	32	40	50	63		25	32	40
øD mm	½"	¾"	1"	1¼"	1½"	2"		½"	¾"	1"
SW1 mm	25	31	38	47	57	70		31	38	47
SW2 mm	34	40	50	59	72	86		40	50	59
Peso/Weight gr.	107	140	279	359	563	862		162	285	369

Art. H.0301 AXO•PE

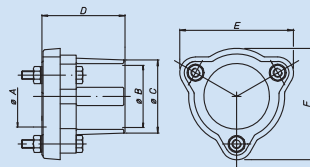

Raccordo diritto femmina flangiato per tubi in polietilene, sabbato.
Straight fitting for PE-pipe, female/flanged, sandblasted.

SIZE	2½"x75	3"x90	4"x110*						
øA mm	75	90	110						
øB mm	2½"	3"	4"						
øC mm	83	98	126						
D mm	105	107	190						
E mm	131	150	180						
F mm	130	149	181						
Peso/Weight gr.	1720	2465	5485						

* IN GHISA / CAST IRON

Art. H.0302 AXO•PE

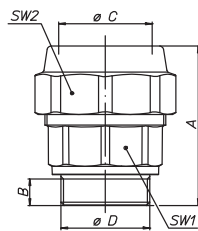

Raccordo diritto maschio per tubi in polietilene, sabbato.
Straight fitting for PE-pipe, male, sandblasted.

SIZE	½"x20	¾"x25	1"x32	1¼"x40	1½"x50	2"x63		½"x25	¾"x32	1"x40
A mm	44	51,3	58,5	65,5	75,5	87,5		49,8	56,7	64,5
B mm	8,7	10,2	11,7	12,7	14,2	16,2		8,7	10,2	11,7
øC mm	20	25	32	40	50	63		25	32	40
øD mm	½"	¾"	1"	1¼"	1½"	2"		½"	¾"	1"
SW1 mm	25	31	38	47	57	70		31	38	47
SW2 mm	34	40	50	59	72	86		40	50	59
Peso/Weight gr.	93	128	229	353	680	820		125	222	324

Art. H.0303 AXO•PE

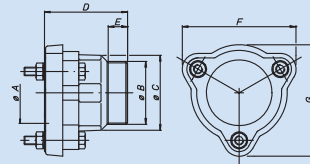
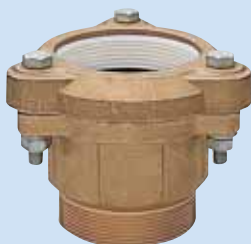

Raccordo diritto maschio flangiato per tubi in polietilene, sabbato.
Straight fitting for PE-pipe, male/flanged, sandblasted.

SIZE	2½"x75	3"x90	4"x110*						
øA mm	75	90	110						
øB mm	2"	3"	4"						
øC mm	83	98	126						
D mm	102	108	190						
E mm	23	23	25						
F mm	131	150	180						
G mm	130	149	181						
Peso/Weight gr.	1860	2460	5250						

* IN GHISA / CAST IRON

Art. H.0304 AXO•PE

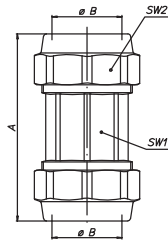

Raccordo diritto bigiunto di accoppiamento per tubi in polietilene, sabbato.
Straight double fitting for PE-pipe, sandblasted.

SIZE	mm 20	mm 25	mm 32	mm 40	mm 50	mm 63	mm 75*	mm 90*	mm 110*
A mm	64,5	75,5	85,5	96,5	113	133	163	178	302
øB mm	20	25	32	40	50	63	75	90	110
SW1 mm	25	31	38	47	57	70	-	-	-
SW2 mm	34	40	50	59	72	86	-	-	-
Peso/Weight gr.	174	218	362	532	850	1288	1453	4040	11000

* IN GHISA / CAST IRON

Art. H.0306 AXO•PE

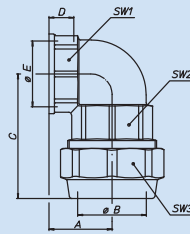

Raccordo a squadra femina per tubi in polietilene, sabbato.
Angled fitting for PE-pipe, female, sandblasted.

SIZE	½"x20	¾"x25	1"x32	1¼"x40	1½"x50	2"x63
A mm	23,5	29,5	34,5	39	46	55
øB mm	20	25	32	40	50	63
C mm	43	52	60	70,5	83,5	100,5
D mm	9,7	11,2	12,7	13,7	15,7	17,7
øE mm	½"	¾"	1"	1¼"	1½"	2"
SW1	25	31	38	47	57	70
SW2	25	31	38	47	57	70
SW3	34	40	50	59	72	86
Peso/Weight gr.	121	190	308	621	788	1214

Art. H.0308 AXO•PE

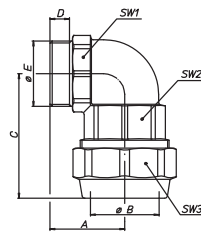

Raccordo a squadra maschio per tubi in polietilene, sabbato.
Angled fitting for PE-pipe, male, sandblasted.

SIZE	½"x20	¾"x25	1"x32	1¼"x40	1½"x50	2"x63
A mm	28	33	40	47	54	64,5
øB mm	20	25	32	40	50	63
C mm	43	52	60	70,5	83,5	100,5
D mm	8,7	10,2	11,7	12,7	14,2	16,2
øE mm	½"	¾"	1"	1¼"	1½"	2"
SW1 mm	25	31	38	47	57	70
SW2 mm	25	31	38	47	57	70
SW3 mm	34	40	50	59	72	80
Peso/Weight gr.	128	184	330	532	836	1622

Art. H.0310 AXO•PE

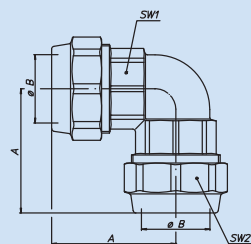

Raccordo a squadra bigiunto di accoppiamento per tubi in polietilene, sabbato.
Angled double fitting for PE-pipe, sandblasted.

SIZE	mm 20	mm 25	mm 32	mm 40	mm 50	mm 63
A mm	43	52	60	70,5	83,5	100,5
øB mm	20	25	32	40	50	63
SW1 mm	25	31	38	47	57	70
SW2 mm	34	40	50	59	72	86
Peso/Weight gr.	170	254	436	812	1104	1661

AXO • PE

Raccordo per tubi PE con guarnizione tronco-conica
Fitting for PE-pipe with tapered gasket

Art. H.0312 AXO•PE

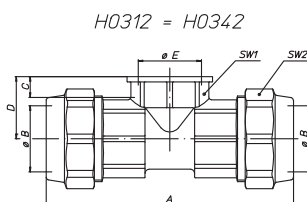

Raccordo a "T" femmina per tubi in polietilene, sabbato.
T-fitting for PE-pipe, female, sandblasted.

SIZE	½"x20	¾"x25	1"x32	1 ¼"x40	1 ½"x50	2"x63			
A mm	80,5	96,5	112,5	131	156	187			
øB mm	20	25	32	40	50	63			
C mm	9,7	11,2	12,7	13,7	15,7	17,7			
D mm	23,5	29,5	34,5	39	46	55			
øE mm	½"	¾"	1"	1 ¼"	1 ½"	2"			
SW1 mm	34	40	50	59	72	86			
SW2 mm	25	31	38	47	57	70			
Peso/Weight gr.	190	284	502	720	1360	2548			

Art. H.0316 AXO•PE

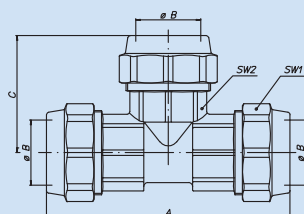

Raccordo a "T" di accoppiamento per tubi in polietilene, sabbato.
T-fitting for PE-pipe, sandblasted.

SIZE	mm 20	mm 25	mm 32	mm 40	mm 50	mm 63			
A mm	80,5	96,5	112,5	131	156	187			
øB mm	20	25	32	40	50	63			
C mm	43,5	52	60	70,5	83,5	100,5			
SW1 mm	25	31	38	47	57	70			
SW2 mm	34	40	50	59	72	86			
Peso/Weight gr.	244	352	610	992	1643	2940			