

BASIC • HT

Valvola a sfera per acqua surriscaldata
Ball valve for hot water

Art. S.3084 BASIC•HT

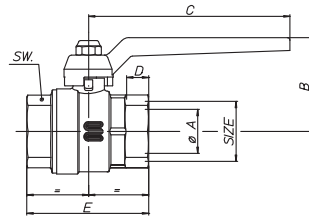

Valvola a sfera per **alta temperatura** a passaggio totale con leva alluminio, femmina/femmina, nichelata.

Full bore ball valve for **high temperature**, with aluminium lever handle, female/female, nickel-plated.

SIZE	¾"	½"	¾"	1"	1¼"	1½"	2"			
øA pass./bore	10	15	20	25	32	40	50			
B mm	38,5	40	49,5	53,5	64	74,5	90			
C mm	80	80	115	115	130	150	170			
D mm	11,4	9,5	11	12,5	13,5	15,5	17,5			
E mm	49,5	49	59	70	81	94	112			
SW mm	21	25	31	38	47	54	66			
Peso/Weight gr.	135	163	284	448	758	1300	2173			

Art. S.3085 BASIC•HT

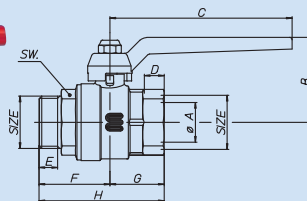

Valvola a sfera per **alta temperatura** a passaggio totale con leva alluminio, maschio/femmina, nichelata.

Full bore ball valve for **high temperature**, with aluminium lever handle, male/female, nickel-plated.

SIZE	½"	¾"	1"	1¼"	1½"	2"				
øA pass./bore	15	20	25	32	40	50				
B mm	40	49,5	53,5	64	74,5	90				
C mm	80	115	115	130	150	170				
D mm	9,5	11	12,5	13,5	15,5	17,5				
E mm	9,7	10,7	11,7	13,2	14,7	16,7				
F mm	35	40,5	44,4	51	57	66				
G mm	24,5	29,5	35	40,5	47	56				
H mm	59,5	70	79,5	91,5	104	122				
SW mm	25	31	38	47	54	66				
Peso/Weight gr.	192	330	530	864	1408	2259				

Art. S.1301 BASIC•HT

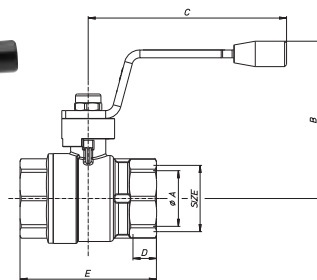

Valvola a sfera per **alta temperatura** a passaggio totale con **leva acciaio con indicazione di temperatura**, femmina/femmina, nichelata.

Full bore ball valve for **high temperature**, with **steel lever with temperature indicator**, female/female, nickel-plated.

SIZE	¾"	1"								
øA pass./bore	20	25								
B mm	74	81								
C mm	102	102								
D mm	12,5	13,5								
E mm	70	81								
SW mm	31	38								

Art. S.1302 BASIC•HT

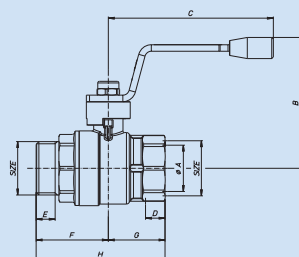

Valvola a sfera per **alta temperatura** a passaggio totale con **leva acciaio con indicazione di temperatura**, maschio/femmina, nichelata.

Full bore ball valve for **high temperature**, with **steel lever with temperature indicator**, male/female, nickel-plated.

SIZE	¾"	1"								
øA pass./bore	20	25								
B mm	74	81								
C mm	102	102								
D mm	12,5	13,5								
E mm	11,7	13,2								
F mm	44,5	51								
G mm	35	40,5								
H mm	79,5	91,5								
SW mm	31	38								