

BASIC

Valvola a sfera a passaggio totale serie universale

Full bore ball valve standard series

Art. S.0211 BASIC

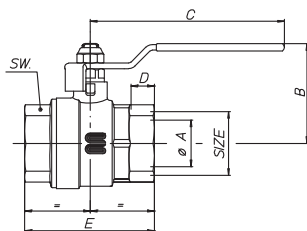
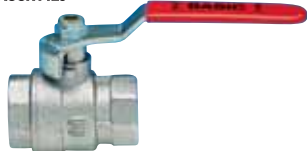

Valvola a sfera passaggio totale con leva ferro, femmina/femmina, nichelata.
Full bore valve with steel handle, female/female, nickel-plated.

SIZE	¼"	¾"	½"	¾"	1"	1¼"	1½"	2"	2½"	3"	4"
ØA pass./bore	10	10	15	20	25	32	40	50	65	80	100
B mm	38	38	39,5	47,5	51,5	62	71	85,5	98,5	112,5	135
C mm	90	90	90	105	105	120	140	170	170	250	250
D mm	11	11,4	9,5	11	12,5	13,5	15,5	17,5	19,5	21	24,3
E mm	47,5	49,5	49	59	70	81	94	112	134	156	189
SW mm	17	21	25	31	38	47	54	66	83	97	124
Peso/Weight gr.	140	153	182	307	465	795	1330	2280	3202	5376	9080

Art. S.0212 BASIC

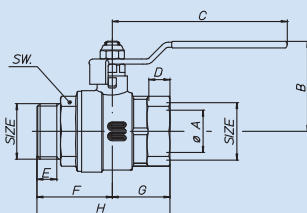

Valvola a sfera passaggio totale con leva ferro, maschio/femmina, nichelata.
Full bore valve with steel handle, male/female, nickel-plated.

SIZE	½"	¾"	1"	1¼"	1½"	2"				
ØA pass./bore	15	20	25	32	40	50				
B mm	39,5	47,5	51,5	62	71	85,5				
C mm	90	105	105	120	140	170				
D mm	9,5	11	12,5	13,5	15,5	17,5				
E mm	9,7	10,7	11,7	13,2	14,7	16,7				
F mm	35	40,5	44,5	47,5	54,5	65				
G mm	24,5	29,5	35	40,5	47	56				
H mm	59,5	70	79,5	98	101,5	121				
SW mm	25	31	38	47	54	66				
Peso/Weight gr.	209	351	551	898	1437	2297				

Art. S.3212 BASIC

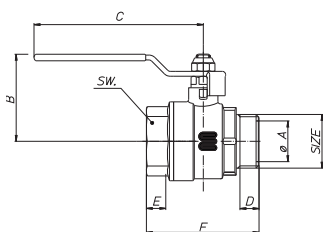
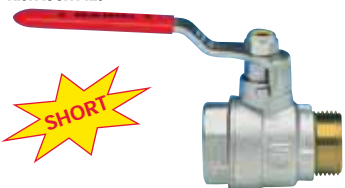

Valvola a sfera passaggio totale con leva ferro, maschio/femmina, nichelata.
Full bore valve with steel handle, male/female, nickel-plated.

SIZE	½"	¾"	1"	1¼"	1½"	2"				
ØA pass./bore	15	20	25	32	39	48				
B mm	39,5	47,5	51,5	72	74	80				
C mm	90	105	105	120	140	170				
D mm	9,7	10,7	11,7	17	20	20				
E mm	9,5	11	12,5	13,5	15,5	17,5				
F mm	49	59	70	81	94	112				
SW mm	25	31	38	47	54	66				
Peso/Weight gr.	187	316	463	874	1200	2200				

Art. S.0213 BASIC

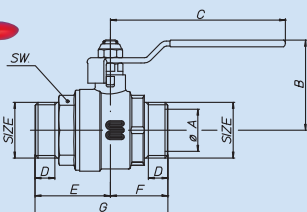
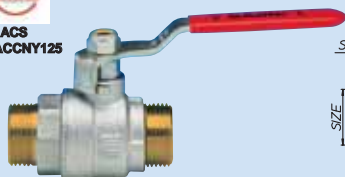

Valvola a sfera passaggio totale con leva ferro, maschio/maschio, nichelata.
Full bore ball valve with steel handle, male/male, nickel-plated.

SIZE	½"	¾"	1"	1¼"	1½"	2"				
ØA pass./bore	15	20	25	32	39	48				
B mm	39,5	47,5	51,5	72	74	80				
C mm	90	105	105	120	140	170				
D mm	9,7	10,7	11,7	17	20	20				
E mm	35	40,5	44,5	47,7	54,5	65				
F mm	24,5	29,5	35	40,5	47,5	56				
G mm	59,5	70	79,5	97	110	125				
SW mm	25	31	38	47	54	66				
Peso/Weight gr.	210	354	524	890	1430	2400				

Art. S.0214 BASIC

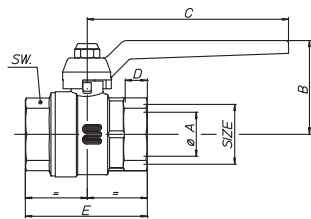

Valvola a sfera passaggio totale con leva alluminio, femmina/femmina, nichelata.
Full bore ball valve with aluminium lever, female/female, nickel-plated.

SIZE	¼"	¾"	½"	¾"	1"	1¼"	1½"	2"	2½"	3"	4"
øA pass./bore	10	10	15	20	25	32	40	50	65	80	100
B mm	38,5	38,5	40	49,5	53,5	64	74,5	90	105,5	119,5	142
C mm	80	80	80	115	115	130	150	170	170	235	235
D mm	11	11,4	9,5	11	12,5	13,5	15,5	17,5	19,5	21	24
E mm	47,5	49,5	49	59	70	81	94	112	134	156	189
SW mm	17	21	25	31	38	47	54	66	83	97	124
Peso/Weight gr.	122	135	163	284	448	758	1300	2173	3146	5345	10100

Art. S.0215 BASIC

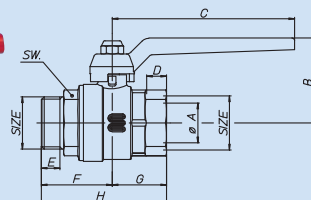

Valvola a sfera passaggio totale con leva alluminio, maschio/femmina, nichelata.
Full bore ball valve with aluminium lever, male/female, nickel-plated.

SIZE	½"	¾"	1"	1¼"	1½"	2"				
øA pass./bore	15	20	25	32	40	50				
B mm	40	49,5	53,5	64	74,5	90				
C mm	80	115	115	130	150	170				
D mm	9,5	11	12,5	13,5	15,5	17,5				
E mm	9,7	10,7	11,7	13,2	14,7	16,7				
F mm	35	40,5	44,4	51	57	66				
G mm	24,5	29,5	35	40,5	47	56				
H mm	59,5	70	79,5	91,5	104	122				
SW mm	25	31	38	47	54	66				
Peso/Weight gr.	192	330	530	864	1408	2259				

Art. S.0216 BASIC

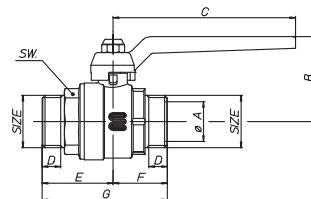

Valvola a sfera passaggio totale con leva alluminio, maschio/maschio, nichelata.
Full bore ball valve with aluminium lever, male/male, nickel-plated.

SIZE	½"	¾"	1"	1¼"	1½"	2"				
øA pass./bore	15	20	25	32	40	50				
B mm	40	49,5	53,5	64	74,5	90				
C mm	80	115	115	130	150	170				
D mm	9,7	10,7	11,7	13,2	14,7	16,7				
E mm	34,75	40,5	44,5	47,7	54,5	65				
F mm	24,75	29,5	35	40,5	47,5	56				
G mm	59,5	70	79,5	88	102	121				
SW mm	25	31	38	47	54	66				
Peso/Weight gr.	130	315	501	865	1400	2370				

Art. S.3215 BASIC

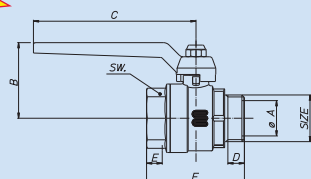

Valvola a sfera passaggio totale con leva alluminio, maschio/femmina, nichelata.
Full bore ball valve with aluminium lever, male/female, nickel-plated.

SIZE	½"	¾"	1"	1¼"	1½"	2"				
øA pass./bore	15	20	25	32	39	48				
B mm	40	49,5	53,5	64	74,5	90				
C mm	80	115	115	130	150	170				
D mm	9,7	10,7	11,7	17	20	20				
E mm	9,5	11	12,5	13,5	15,5	17,5				
F mm	49	59	70	81	94	112				
SW mm	25	31	38	47	54	66				
Peso/Weight gr.	160	282	448	840	1170	2170				

BASIC

Valvola a sfera a passaggio totale serie universale
Full bore ball valve standard series

Art. S.0217 BASIC

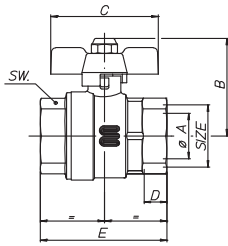

Valvola a sfera passaggio totale con farfalla, femmina/femmina, nichelata.
Full bore ball valve with T-handle, female/female, nickel-plated.

SIZE	1/4"	3/8"	1/2"	3/4"	1"					
øA pass./bore	10	10	15	20	25					
B mm	34,5	34,5	38	47	51					
C mm	52	52	52	65	65					
D mm	7	8,5	9,5	11	12,5					
E mm	38	43	49	59	70					
SW mm	17	21	25	31	38					
Peso/Weight gr.	108	120	165	273	437					

Art. S.0218 BASIC

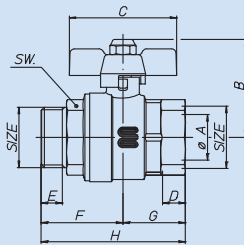

Valvola a sfera passaggio totale con farfalla, maschio/femmina, nichelata.
Full bore ball valve with T-handle, male/female, nickel-plated.

SIZE	1/2"	3/4"	1"							
øA pass./bore	15	20	25							
B mm	38	47	51							
C mm	52	65	65							
D mm	9,5	11	12,5							
E mm	9,7	10,7	11,7							
F mm	35	40,5	44,4							
G mm	24,5	29,5	35							
H mm	59,5	70	79,5							
SW mm	25	31	38							
Peso/Weight gr.	187	317	517							

Art. S.0219 BASIC

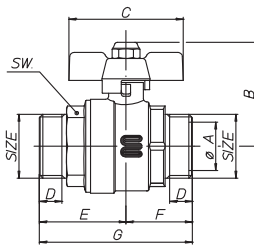
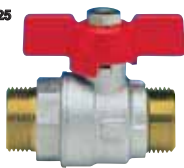

Valvola a sfera passaggio totale con farfalla, maschio/maschio, nichelata.
Full bore ball valve with T-handle, male/male, nickel-plated.

SIZE	1/2"	3/4"	1"							
øA pass./bore	15	20	25							
B mm	38	47	51							
C mm	52	65	65							
D mm	9,7	10,7	11,7							
E mm	35	40,5	44,5							
F mm	24,5	29,5	35							
G mm	59,5	70	79,5							
SW mm	25	31	38							
Peso/Weight gr.	188	320	500							

Art. S.3218 BASIC

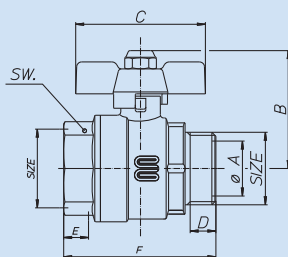
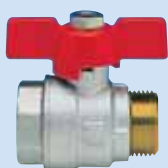

Valvola a sfera passaggio totale con farfalla, maschio/femmina, nichelata.
Full bore ball valve with T-handle, male/female, nickel-plated.

SIZE	1/2"	3/4"	1"							
øA pass./bore	15	20	25							
B mm	40	49,5	53,5							
C mm	52	65	65							
D mm	9,7	10,7	11,7							
E mm	9,5	11	12,5							
F mm	49	59	70							
SW mm	25	31	38							
Peso/Weight gr.	164	283	438							

Art. S.0226 BASIC

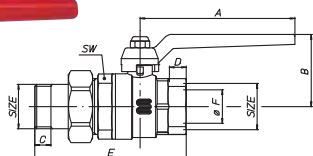

Valvola a sfera per collettori femmina/codola maschio con leva alluminio rossa, nichelata.

Full bore ball valve with nut and tail, with aluminium lever, male/female, nickel-plated.

SIZE	1/2"	3/4"	1"	1 1/4"				
A mm	80	115	115	130				
B mm	40,5	48,5	52,5	54,5				
C mm	10	12	12	15				
D mm	9,5	11	12,5	21,4				
E mm	83	96	112,5	129				
øF pass./bore	15	20	25	25				
SW mm	27	34	43	49				
Peso/Weight gr.	273	464	740	893				

Art. S.0227 BASIC

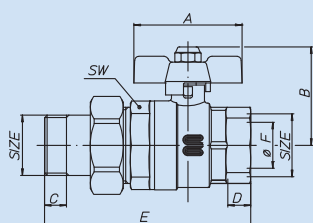
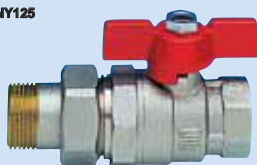

Valvola a sfera per collettori femmina/codola maschio con farfalla rossa, nichelata.

Full bore ball valve with nut and tail, with T-handle, male/female, nickel-plated.

SIZE	1/2"	3/4"	1"	1 1/4"				
A mm	52	65	65	65				
B mm	39	48	52	53				
C mm	10	12	12	15				
D mm	9,5	11	12,5	21,4				
E mm	83	96	112,5	130				
øF pass./bore	15	20	25	25				
SW mm	27	34	43	49				
Peso/Weight gr.	268	430	727	881				

Art. S.3226 BASIC

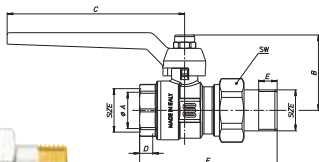

Valvola a sfera per collettori femmina/codola maschio con leva alluminio rossa, nichelata.

Full bore ball valve with nut and tail, with aluminium lever, male/female, nickel-plated.

SIZE	1/2"	3/4"	1"	1 1/4"				
A mm	15	20	25	32				
B mm	39	48	52	59,5				
C mm	80	115	115	130				
D mm	9,5	11	12,5	13,5				
E mm	10	12	12	15				
F mm	73	88	103	122				
SW mm	25	31	38	47				
Peso/Weight gr.	226	413	699	974				

Art. S.3227 BASIC

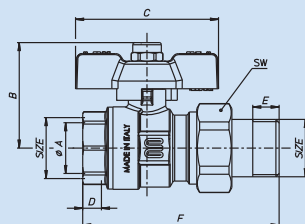

Valvola a sfera per collettori femmina/codola maschio con farfalla rossa, nichelata.

Full bore ball valve with nut and tail, with T-handle, male/female, nickel-plated.

SIZE	1/2"	3/4"	1"					
A pass./bore	15	20	25					
B mm	39	48	52					
C mm	52	65	65					
D mm	9,5	11	12,5					
E mm	10	12	12					
F mm	73	88	103					
SW mm	25	31	38					
Peso/Weight gr.	222	400	646					

BASIC

Valvola a sfera a passaggio totale serie universale

Full bore ball valve standard series

Art. S.0228 BASIC

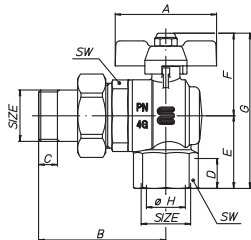
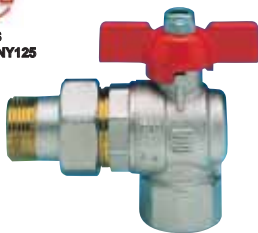

Valvola a sfera a squadra per collettori femmina/codola maschio con farfalla rossa, nichelata.

Angled full bore ball valve with nut and tail, with T-handle, female/male, nickel-plated.

SIZE	1/2"	3/4"	1"						
A mm	52	65	65						
B mm	60,5	70	81,5						
C mm	10	12	12						
D mm	15	16,3	19,1						
E mm	33	39	46,5						
F mm	40	49	53						
G mm	73	88	99,5						
øH pass./bore	15	20	25						
SW mm	26	32	39						
Peso/Weight gr.	292	493	772						

Art. S.0229 BASIC

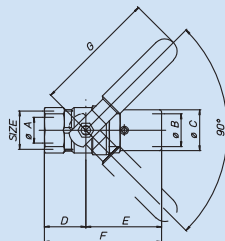

Valvola a sfera femmina/manicotto cilindrico liscio con leva acciaio rossa, nichelata.

Female ball valve for deep fryers, with red steel lever, nickel-plated.

SIZE	3/4"								
øA pass./bore	17,5								
øB mm	22,3								
øC mm	29,5								
D mm	30								
E mm	55								
F mm	85								
G mm	90								
Peso/Weight gr.	330								

Art. S.0242 - S.0245 BASIC

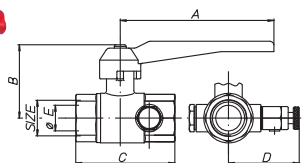

Valvola a sfera passaggio totale

Art. S0245 rubinetto per spurgo.

Art. S0242 attacco portagomma.

Art. S0245 Full bore drain valve, with hose connector.

Art. S0242 Full bore drain valve, without hose connector.

SIZE	1/2"	3/4"	1"	1 1/4"	1 1/2"	2"			
A mm	75	95	95	115	150	150			
B mm	43	52	56	71	81	89			
C mm	54	60,5	74	84	96	110			
D mm	55	58	62	66	71	78			
ø E pass./bore	15	20	25	32	40	50			
Peso/Weight gr.	235	345	535	890	1250	1720			

Art. S.0320 MINI-PUMP

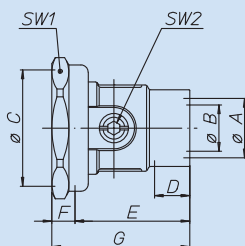

Valvola a sfera fil. femmina con flangia per attacco pompe, con girello, sabbata.

Ball valve for pumps, female threaded, with hexagonal nut.

SIZE	1 1/2x3/4"	1 1/2x1"							
øA	3/4"	1"							
øB pass./bore	19	19							
øC	1 1/2"	1 1/2"							
D mm	14,5	15,7							
E mm	47,3	49							
F mm	9,5	9,5							
G mm	56,8	58,5							
SW1 mm	52	52							
SW2 mm	5	5							
Peso/Weight gr.	293	307							

Art. S.0321 MINI•PUMP

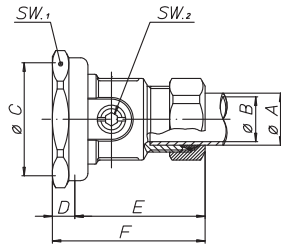

Valvola a sfera con anello di compressione per tubo rame, con dado esagonale.
Ball valve for pumps, compression ring connection for copper pipe, with hexagonal nut.

SIZE	1" 1/2x22	1" 1/2x28							
øA mm	22	28							
øB pass./bore	19	19							
øC	1" 1/2	1" 1/2							
D mm	9,5	9,5							
E mm	52,5	53,5							
F mm	62	63							
Peso/Weight gr.	334	334							

Art. S.0460 BASIC•BRAVO

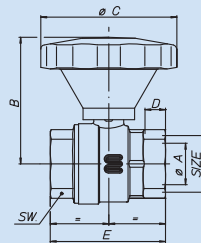

Valvola a sfera a passaggio totale con manopola di riduzione BRAVO, femmina/femmina, nichelata.
Full bore ball valve with BRAVO gear handle, female/female, nickel-plated.

SIZE	1/4"	3/8"	1/2"	3/4"	1"	1" 1/4"	1" 1/2"	2"		
øA pass./bore	10	10	15	20	25	32	40	50		
B mm	67	67	68	74	78	114,5	121	130		
øC mm	82	82	82	82	82	128	128	128		
D mm	7	8,5	9,5	11	12,5	13,5	15,5	17,5		
E mm	38	43	49	59	70	81	94	112		
SW mm	17	21	25	31	38	47	54	66		
Peso/Weight gr.	175	187	226	330	514	969	1435	2314		

Art. S.0464 BASIC•XT

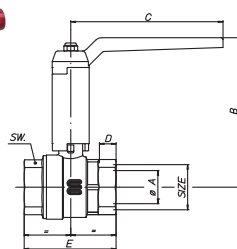

Valvola a sfera a passaggio totale con prolunga XT, femmina/femmina, nichelata.
Full bore ball valve with extended stem, female/female, nickel-plated.

SIZE	1/4"	3/8"	1/2"	3/4"	1"	1" 1/4"	1" 1/2"	2"	2" 1/2"	3"	4"
øA pass./bore	10	10	15	20	25	32	40	50	65	80	100
B mm	96,5	96,5	97,5	107	111	121,5	131	146,5	161	175	190
C mm	80	80	80	115	115	130	150	170	170	235	235
D mm	7	8,5	9,5	11	12,5	13,5	15,5	17,5	19,5	21	24,3
E mm	38,5	43,5	49	58,5	70	80,5	94	111,5	134	156	189
SW mm	17	21	25	31	38	47	54	66	83	97	124
Peso/Weight gr.	194	206	245	387	571	911	1469	2438	3399	6120	-

Art. S.0472 BASIC•XT•MONOBLOCCO

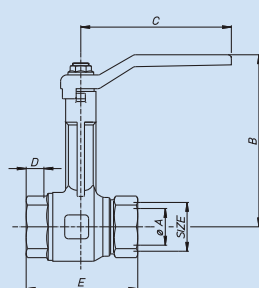

Valvola a sfera femmina/femmina passaggio totale, nichelata con prolunga monoblocco.
Full bore ball valve, with monoblock extended stem, female/female, nickel-plated.

SIZE	1/2"	3/4"	1"	1" 1/4"	1" 1/2"	2"			
øA pass./bore	15	20	25	32	40	50			
B mm	90	93	102	116	122	137			
C mm	82	82	93	117	117	145			
D mm	13	13	15	18	18	20			
E mm	54	59	69	83	92	110			
KV mm	15,5	31,7	58,5	96	160	269			

BASIC

Con serratura
With locking device

Valvola a sfera con serratura a doppia funzione Ball valve with double-function locking device



VANTAGGI

Sistema di chiusura sicuro. Sistema di morosità pratico e veloce, che evita il laborioso fissaggio, mediante la tradizionale piombatura con il filo. Due chiavi per l'utente (di colore grigio) fornite insieme alla valvola. Una chiave maestra per il responsabile dell'impianto che funge sia da passepartout che da morosità (di colore giallo) fornita solo a richiesta.

N° 100 combinazioni sotto la stessa chiave maestra.

IMPIEGHI

Impianti di distribuzione e cisterne di stoccaggio per acqua, o vari liquidi che si vogliono tenere protetti dall'uso pubblico.

La serratura è montata sulle valvole della serie BASIC, adatte sia per acqua che per altri liquidi compatibili.

ADVANTAGES

Safe locking device.

Practical and rapid rearrange system which replaces the laborious fixing through the traditional wire-leading. Two grey keys are given to the user together with the valve.

The person in charge of the system can receive a master key, which suits all the locks and can be used in case of rearrange. It is a yellow key and it is available only upon request.

The same yellow key can be used for 100 different combinations.

USES

Mainly used in distribution systems, water supply storage tanks or other fluids you want to prevent from free public use.

The locking device is assembled on the valve of the BASIC range, which are suitable for both water applications and for other compatible fluids.

POSIZIONE NORMALE NORMAL POSITION

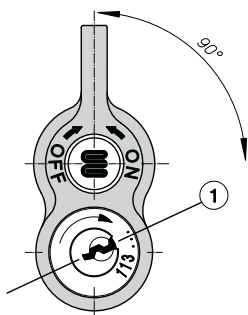

1- Con la chiave in questa posizione la valvola funziona normalmente ON-OFF e la chiave NON PUÒ essere estratta.

1- When the key is in this position, the valve works normally ON-OFF and the key itself CANNOT be taken away.

POSIZIONE DI BLOCCAGGIO UTENTE USER LOCKING POSITION

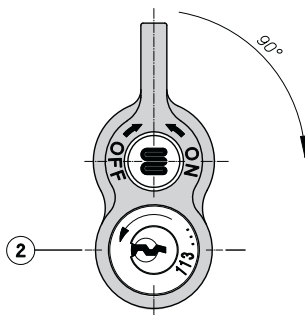

2- Con la chiave in questa posizione la valvola può essere bloccata in posizione OFF e la chiave PUÒ essere estratta.

2- When the key is in this position, the valve can be locked in the OFF position and the key CAN be taken away.

POSIZIONE DI MOROSITÀ ARRANGE POSITION

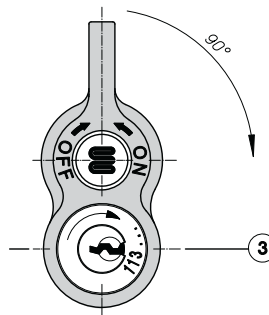

POSIZIONE ATTIVABILE CON LA SOLA CHIAVE PASSEPARTOUT

3- Con la chiave in questa posizione la valvola può essere bloccata in posizione OFF e NON PUÒ essere bloccata con la chiave utente. (Chiave gialla in dotazione all'ente erogatore).

ONLY THE MASTER KEY CAN ACTIVATE THE POSITION

3- When the key is in this position, the valve can be locked in the OFF position and it CANNOT be opened with the user's key (yellow key given to the company).

RITORNO POSIZIONE NORMALE RETURN TO THE NORMAL POSITION

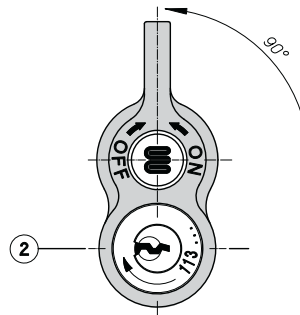

4- Con la chiave riportata in questa posizione dall'ente erogatore la valvola ritorna a funzionare normalmente.

4- When the key is put back in this position by the supplier, the valve can work normally.

Art. S.1361 BASIC

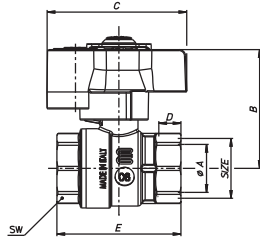

Valvola a sfera a passaggio totale con serratura, femmina/femmina, nichelata.
Full bore ball valve with key-locking device, female/female, nickel-plated.

SIZE	½"	¾"	1"						
A mm	15	20	25						
B mm	53,5	56	60						
C mm	66	66	66						
D mm	9,5	11	12,5						
E mm	49	58,5	70						
SW mm	25	31	38						

Art. S.1362 BASIC

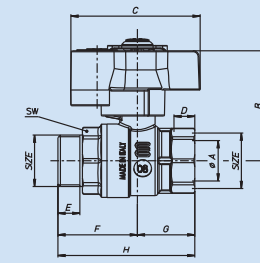

Valvola a sfera a passaggio totale con serratura, maschio/femmina, nichelata.
Full bore ball valve with key-locking device, male/female, nickel-plated.

SIZE	½"	¾"	1"						
A mm	15	20	25						
B mm	53,5	56	60						
C mm	66	66	66						
D mm	9,5	11	12,5						
E mm	9,7	10,7	11,7						
F mm	35	40,5	44,5						
G mm	24,5	29,5	35						
H mm	59,5	70	79,5						
SW mm	25	31	38						

Art. S.1364 BASIC

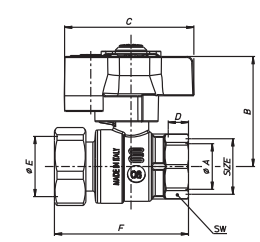

Valvola a sfera a passaggio totale con serratura, femmina/girello, nichelata.
Full bore ball valve with key-locking device, female/nut, nickel-plated.

SIZE	½"	¾"	1"						
øA pass./bore	15	20	25						
B mm	53,5	56	60						
C mm	66	66	66						
D mm	9,5	11	12,5						
E	¾"	1"	1¼"						
F mm	57	68	83						
SW mm	25	31	38						