

ROBEX • VT

Valvola tripla
Triple valve

Art. S.0370 ROBEX•VT

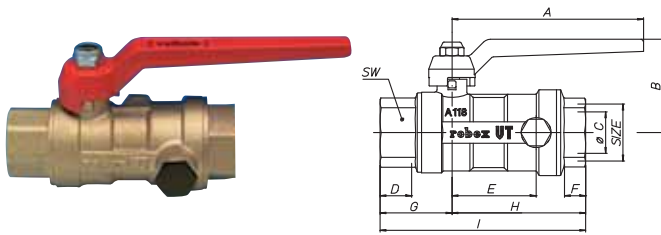

Valvola a sfera con valvola di ritegno, femmina/femmina a due prese, con tappi, con leva, sabbiata.

Ball valve with a check valve, female/female with two plugged side outlets, with caps, with handle, sandblasted.

SIZE	½"	¾"	1"	1¼"	1½"	2"			
A mm	95	115	115	130	150	170			
B mm	42,5	52	56	65,5	76	87,5			
øC pass./bore	15	20	25	32	40	50			
D mm	15	16,3	19,1	21,4	21,4	25,7			
E mm	33,5	38,5	50,5	59	75	92			
F mm	9,7	11,2	12,7	13,7	15,7	17,7			
G mm	32,5	36,7	43,2	50,7	55,7	66,2			
H mm	58	65,7	80,2	93,7	113,7	139,7			
I mm	90,5	102,5	123,5	144,5	169,5	206			
SW mm	26	32	39	48	55	68			
Peso/Weight gr.	374	585	916	1450	2482	5161			

Art. S.0371 ROBEX•VT

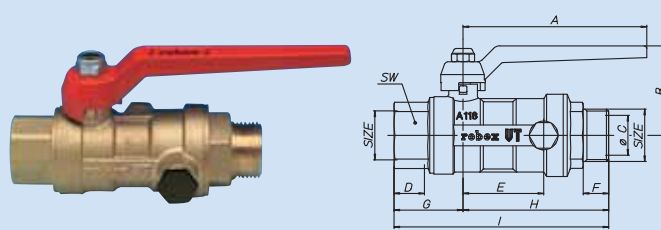

Valvola a sfera con valvola di ritegno, femmina/maschio a due prese, con tappi, con leva, sabbiata.

Ball valve with a check valve, female/male with two plugged side outlets, with caps, with handle, sandblasted.

SIZE	½"	¾"	1"	1¼"	1½"	2"			
A mm	95	115	115	130	150	170			
B mm	42,5	52	56	65,5	76	87,5			
øC pass./bore	15	20	25	32	40	50			
D mm	15	16,3	19,1	21,4	21,4	25,7			
E mm	33,5	38,5	50,5	59	75	92			
F mm	8,7	12,2	13,7	17,2	17,2	21,7			
G mm	32,5	36,7	43,2	50,7	55,7	66,2			
H mm	63,5	76,7	91,2	107,7	127,2	153,2			
I mm	96	113,5	134,5	158,5	183	219,5			
SW mm	26	32	39	48	55	68			
Peso/Weight gr.	383	601	933	1545	2530	5180			

Art. S.0372 ROBEX•VT

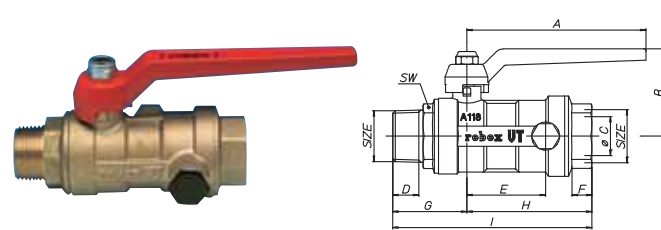

Valvola a sfera con valvola di ritegno, maschio/femmina a due prese, con tappi, con leva, sabbiata.

Ball valve with a check valve, male/female, with two plugged side outlets, with caps, with handle, sandblasted.

SIZE	½"	¾"	1"	1¼"	1½"	2"			
A mm	95	115	115	130	150	170			
B mm	42,5	52	56	65,5	76	87,5			
øC pass./bore	15	20	25	32	40	50			
D mm	11,5	12,9	14,7	17,2	17,2	21,7			
E mm	33,5	38,5	50,5	59	75	92			
F mm	9,7	11,2	12,7	13,7	15,7	17,7			
G mm	36,5	42	47,2	54,2	60,2	72,2			
H mm	58	65,7	80,2	93,7	113,7	139,7			
I mm	94,5	108	127,5	148	174	212			
SW mm	26	32	39	48	55	68			
Peso/Weight gr.	378	601	921	1574	2532	5197			

Art. S.0380 ROBEX•VT

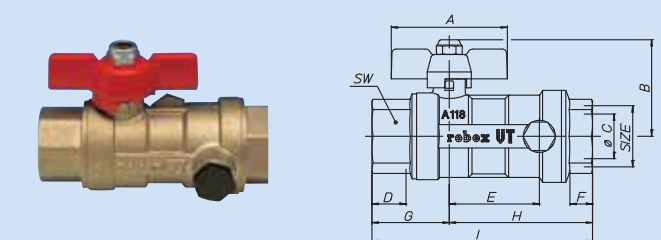

Valvola a sfera con valvola di ritegno, femmina/femmina a due prese, con farfalla, sabbiata.

Ball valve with a check valve, female/female with two plugged side outlets, with caps, with T-handle, sandblasted.

SIZE	½"	¾"	1"						
A mm	52	65	65						
B mm	41	50	54						
øC pass./bore	15	20	25						
D mm	15	16,3	19,1						
E mm	33,5	38,5	50,5						
F mm	9,7	11,2	12,7						
G mm	32,5	36,7	43,2						
H mm	58	65,7	80,2						
I mm	90,5	102,5	123,5						
SW mm	26	32	39						
Peso/Weight gr.	364	572	903						

Art. S.0381 ROBEX•VT

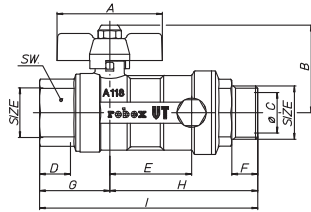

Valvola a sfera con valvola di ritegno, femmina/maschio a due prese, con tappi, con farfalla, sabbiata.

Ball valve with a check valve, female/male with two plugged side outlets, with caps, with T-handle, sandblasted.

SIZE	½"	¾"	1"						
A mm	52	65	65						
B mm	41	50	54						
øC pass./bore	15	20	25						
D mm	15	16,3	19,1						
E mm	33,5	38,5	50,5						
F mm	8,7	12,2	13,7						
G mm	32,5	36,7	43,2						
H mm	63,5	76,7	91,2						
I mm	96	113,5	134,5						
SW mm	26	32	39						
Peso/Weight gr.	385	588	920						

Art. S.0382 ROBEX•VT

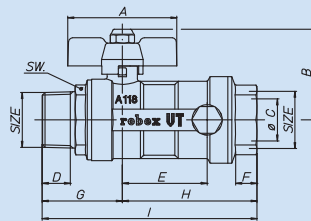
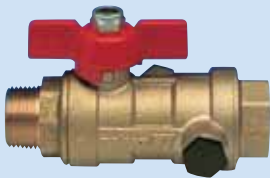

Valvola a sfera con valvola di ritegno, maschio/femmina a due prese, con tappi, con farfalla, sabbiata.

Ball valve with a check valve, male/female, with two plugged side outlets, with caps, with T-handle, sandblasted.

SIZE	½"	¾"	1"						
A mm	52	65	65						
B mm	41	50	54						
øC pass./bore	15	20	25						
D mm	11,5	12,9	14,7						
E mm	33,5	38,5	50,5						
F mm	9,7	11,2	12,7						
G mm	36,5	42	47,2						
H mm	58	65,7	80,2						
I mm	94,5	107,7	127,5						
SW mm	26	32	39						
Peso/Weight gr.	368	588	908						

Art. S.0391 ROBEX•VT

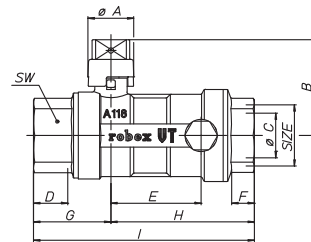

Valvola a sfera con valvola di ritegno, femmina/femmina a due prese, con cappuccio di piombatura, sabbiata.

Ball valve with a check valve, female/female with two plugged side outlets, with caps, with lockable rectangular head, sandblasted.

SIZE	½"	¾"	1"						
øA mm	23	25,5	25,5						
B mm	39,5	49	53,5						
øC pass./bore	15	20	25						
D mm	15	16,3	19,1						
E mm	33,5	38,5	50,5						
F mm	9,7	11,7	12,7						
G mm	32,5	36,75	43,25						
H mm	58	65,75	80,25						
I mm	90,5	102,5	123,5						
SW mm	26	32	39						
Peso/Weight gr.	376	-	-						

Art. S.0400 ROBEX•VT

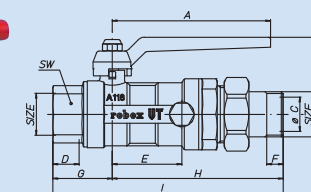

Valvola a sfera con valvola di ritegno, fil. femmina con bocchettone, a due prese con tappi, con leva, sabbiata.

Ball valve with a check valve, female threaded with nut and tail, with two plugged side outlets with caps, with handle, sandblasted.

SIZE	½x½"	¾x¾"	1"x1"	1"½x1"½"	1"½x1"½"				
A mm	95	115	115	130	150				
B mm	42,5	52	56	65,5	76				
øC pass./bore	15	20	25	32	40				
D mm	15	16,3	19,1	21,4	21,4				
E mm	33,5	38,5	50,5	59	75				
F mm	10	12	12	15	20				
G mm	32,5	36,7	43,2	50,7	55,7				
H mm	90	106	125	146	194				
I mm	122,5	143	168	197	250				
SW mm	26	32	39	48	55				
Peso/Weight gr.	440	780	1150	1841	3177				

ROBEX • VT

Valvola tripla
Triple valve

Art. S.0401 ROBEX•VT

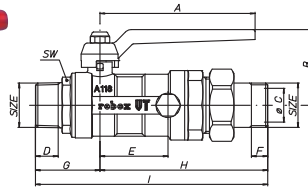

Valvola a sfera con valvola di ritegno, fil. maschio con bocchettone, a due prese con tappi, con leva, sabbiata.

Ball valve with a check valve, male/nut and tail, with two plugged side outlets with caps, with handle, sandblasted.

SIZE	½"x½"	¾"x¾"	1"x1"	1"¼x1"¼	1"½x1"½					
A mm	95	115	115	130	150					
B mm	42,5	52	56	65,5	76					
øC pass./bore	15	20	25	32	40					
D mm	11,5	12,9	14,7	17,2	17,2					
E mm	33,5	38,5	50,5	59	75					
F mm	10	12	12	15	20					
G mm	36,5	42	47,2	54,2	60,2					
H mm	90	106	125	146	194					
I mm	126,5	148	172	200	254					
SW mm	26	32	39	48	55					
Peso/Weight gr.	444	776	1155	1861	3167					

Art. S.0408 ROBEX

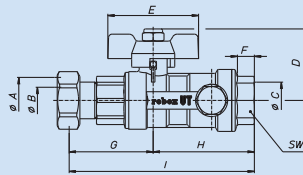

Valvola a sfera con valvola di ritegno, femmina a due prese, con tappi, con girello femmina per attacco contatore, sabbiata.

Ball valve with check valve, female threaded with two plugged side outlets, with caps, with female nut for connection to water meters, sandblasted.

SIZE	¾"x½"	1"x¾"	1"¼x1"							
øA	¾"	1"	1"¼							
øB	15	20	25							
øC	½"	¾"	1"							
D mm	41	50	54							
E mm	52	65	65							
F mm	11,5	13	15							
G mm	48	53	64							
H mm	58	65	80							
I mm	106	118	144							
Peso/Weight gr.	443	702	1125							

Art. S.0428

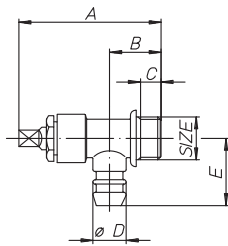

Rubinetto a squadra portagomma per scarico, sabbiato.

Angled drain cock with hose connector, sandblasted.

SIZE	¼"									
A mm	42									
B mm	14,5									
C mm	6									
øD mm	9									
E mm	19,5									
Peso/Weight gr.	35									

Art. S.0429

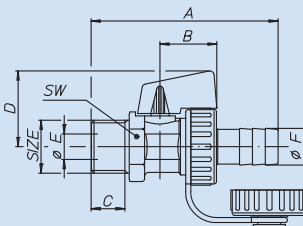
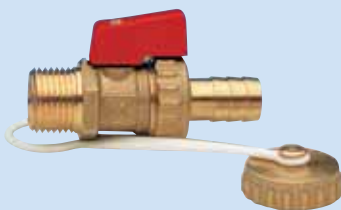

Rubinetto a sfera per scarico caldaie con leva, con tappo e catenella in plastica, sabbiata.

Drain ball cock for heating systems, with handle, with cap and plastic chain, sandblasted.

SIZE	½"									
A mm	72									
B mm	22									
C mm	13,2									
D mm	29									
øE pass./bore	10									
øF mm	14,5									
SW mm	24									
Peso/Weight gr.	142									

Art. S.0430

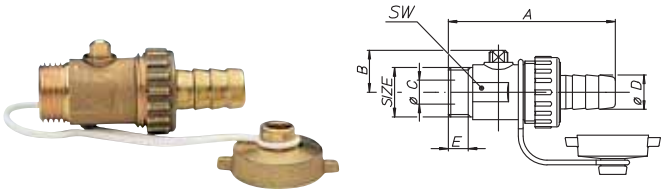

Rubinetto a sfera per scarico caldaia completo, con tappo e catenella in plastica, sabbbiato.
 Drain ball valve for heating systems, with cap and plastic chain, sandblasted.

SIZE	1/2"							
A mm	70							
B mm	17,5							
øC pass./bore	10							
øD mm	14,5							
E mm	8,4							
SW mm	22							
Peso/Weight gr.	128							

Art. S.0431

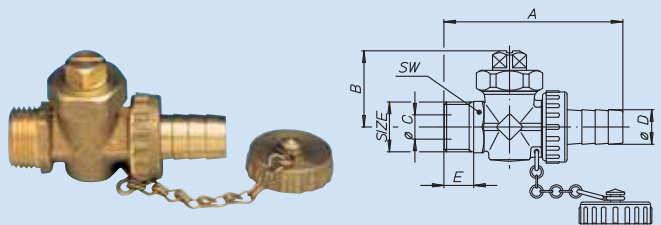

Rubinetto a maschio conico per scarico caldaie completo, con tappo e catenella, sabbbiato.
 Drain ball cock for heating systems, male threaded, with cap and plastic chain, sandblasted.

SIZE	3/8"	1/2"	3/4"					
A mm	74	75	91					
B mm	28,5	31,5	38,5					
øC pass./bore	8	10	13					
øD mm	13	14,5	20					
E mm	9,3	10	12					
SW mm	19	22	28					
Peso/Weight gr.	135	152	315					

Art. S.0490 ROBEX•VT•BRAVO

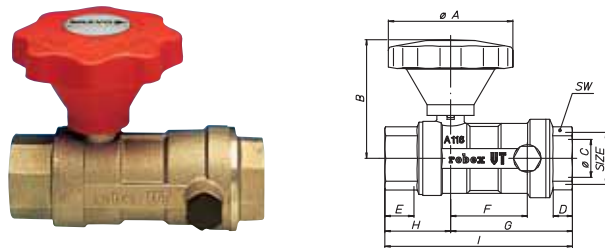

Valvola a sfera con valvola di ritegno due femmine, a due prese, con manopola di riduzione BRAVO, sabbbiato.
 Ball valve with a check valve, female/female, with two plugged side outlets, with BRAVO gear handle, sandblasted.

SIZE	1/2"	3/4"	1"	1 1/4"	1 1/2"	2"		
øA mm	82	82	82	128	128	128		
B mm	68,5	75	79	115	122	130,5		
øC pass./bore	15	20	25	32	40	50		
D mm	9,7	11,7	12,7	13,7	15,7	17,7		
E mm	15	16,3	19,1	21,4	21,4	25,7		
F mm	33,5	38,5	50,5	59	75	92		
G mm	58	65,7	80,2	93,7	113,7	139,7		
H mm	32,5	36,7	43,2	50,7	55,7	66,2		
I mm	90,5	102,5	123,5	144,5	169,5	206		
SW mm	26	32	39	48	55	68		
Peso/Weight gr.	430	629	960	1757	2650	5284		

Art. S.0494 ROBEX•VT•XT

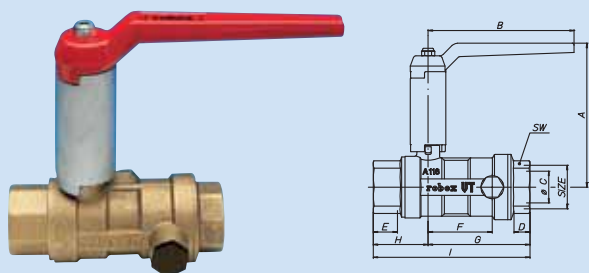

Valvola a sfera con valvola di ritegno due femmine, a due prese con prolunga XT, con leva rossa, sabbbiato.
 Ball valve with a check valve, with two plugged side outlets, with XT extended stem, with red handle, sandblasted.

SIZE	1/2"	3/4"	1"	1 1/4"	1 1/2"	2"		
A mm	98	108,5	112,5	122	132	144		
B mm	95	115	115	130	150	170		
øC pass./bore	15	20	25	32	40	50		
D mm	9,7	11,7	12,7	13,7	15,7	17,7		
E mm	15	16,3	19,1	21,4	21,4	25,7		
F mm	33,5	38,5	50,5	59	75	92		
G mm	58	65,7	80,2	93,7	113,7	139,7		
H mm	32,5	36,7	43,2	50,7	55,7	66,2		
I mm	90,5	102,5	123,5	144,5	169,5	206		
SW mm	26	32	39	48	55	68		
Peso/Weight gr.	454	686	1017	1699	2650	5408		