

BALL•O•MATIC® 3-WAY

Valvola a sfera per attuatori serie pesante a 3 vie
3-way ball valve for actuators heavy series

ART. S.1070 BALL•O•MATIC T-PORT

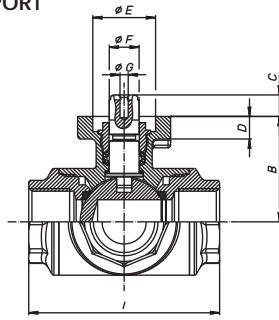

Valvola a sfera 3 Vie, passaggio totale con sfera a "T"
3-way ball valve, full bore with T-port.

ART. S.1071 BALL•O•MATIC L-PORT

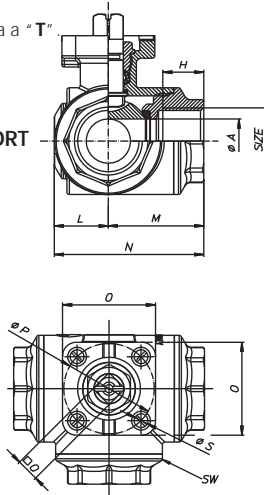

Valvola a sfera 3 Vie, passaggio totale con sfera a "L"
3-way ball valve, full bore with L-port.

Size	1/4"	3/8"	1/2"	3/4"	1"	1 1/4"	1 1/2"	2"
øA pass./bore	8	10	15	20	25	32	40	50
B mm	38	38	38	42	46,5	61,5	63,5	74
C mm	9	9	9	9	9	11	11	14
D mm	9	9	9	9	9	10	10	12
øE H8	25	25	25	25	25	30	30	35
øF	10,8	10,8	10,8	11,9	11,9	13,9	13,9	17,9
øG	M4	M4	M4	M4	M4	M4	M4	M5
H mm	15	15	15	16,3	19,1	21,4	21,4	25,7
I mm	64,5	64,5	64,5	76	97	118	135	157
L mm	17	17	17	21,5	26	36	37,5	43
M mm	32,5	32,5	32,5	38	48,5	59	67,5	78,5
N mm	49,5	49,5	49,5	59,56	74,5	95,5	105	121,5
O mm	37	37	37	37	42	48	48	48
øP	F3	F3	F3	F3	F3-F4	F4-F5	F4-F5	F5
□Q	9	9	9	9	9	11	11	11
øS	5,5	5,5	5,5	5,5	5,5	5,5-6,5	5,5-6,5	6,5
SW mm	25	25	25	31	41	55	55	67
ISO FLANGE	F03	F03	F03	F03	F03/F04	F04/F05	F04/F05	F05

ART. S.1072 LEVA / LEVER

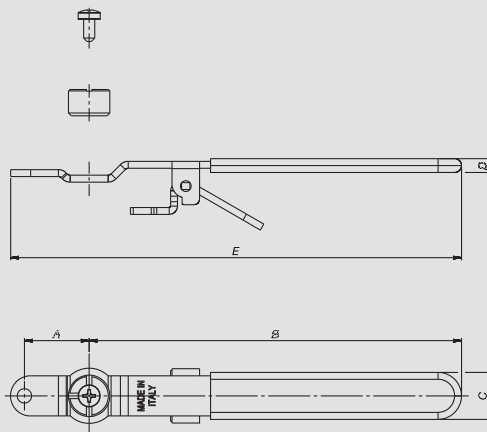

Leva in acciaio posizionabile a 360°
Steel lever, it can be positioned at 360°C.

Size	1/4"-3/8"-1/2"-3/4"-1"	1 1/4" - 1 1/2"	2"
A	23,5	28,5	29
B	135	156,5	192
C	17	17	27
D	5	6	10
E	163,5	189,5	225,5

ART. S.1073 BALL•O•MATIC 3 VIE / 3-WAY T-PORT ART. S.1074 BALL•O•MATIC 3 VIE / 3-WAY L-PORT

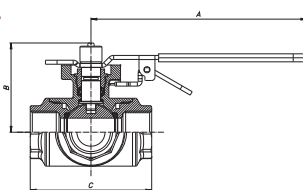

Valvola a sfera a 3 vie con leva in acciaio posizionabile a 360° con sfera a "T" (S.1073) o a "L" (S.1074).
Ball valve full bore with steel lever that can be positioned at 360° with T-port (S.1073) or L-port (S.1074).

Size	1/4"	3/8"	1/2"	3/4"	1"	1 1/4"	1 1/2"	2"
A mm	135	135	135	135	135	156	156	192
B mm	52	52	52	56	60,5	77,5	79,5	93
C mm	64,5	64,5	64,5	76	97	118	135	157

ART. S.4051
BALL•O•MATIC 3 VIE / 3-WAY
ON-OFF

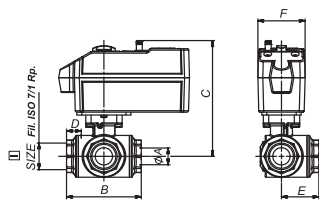

Size	1/4"	3/8"	1/2"	3/4"	1"	1 1/4"	1 1/2"	2"
øA	8	10	15	20	25	32	40	50
B	64,5	64,5	64,5	76	97	118	134,5	157
C	114	114	114	118	156,5	181,5	184	194,5
D	15	15	15	15	16,3	19,1	21,4	25,7
E	32,5	32,5	32,5	38	48,5	59	67,5	78,5
F	48	48	48	48	82	98	98	98
SW	25	25	25	31	38	47	55	68

CARATTERISTICHE ATTUATORE

S4051	con sfera a T	230V	50HZ	2 fili	1 MICRO	IP54-65	bidirezionale
S4061	con sfera a T	24V	50HZ	2 fili	1 MICRO	IP54-65	bidirezionale
S4151	con sfera a L	230V	50HZ	2 fili	1 MICRO	IP54-65	bidirezionale
S4161	con sfera a L	24V	50HZ	2 fili	1 MICRO	IP54-65	bidirezionale

Valvola a sfera a 3 vie con attuatore elettrico ON-OFF con sfera a T (S4051 230V - S4061 24V) o a L (S4151 230V - S4161 24V).

FEATURES OF THE ACTUATOR

S4051	with T-port	230V	50HZ	2 wires	1 MICRO	IP54-65	two-way
S4061	with T-port	24V	50HZ	2 wires	1 MICRO	IP54-65	two-way
S4151	with L-port	230V	50HZ	2 wires	1 MICRO	IP54-65	two-way
S4161	with L-port	24V	50HZ	2 wires	1 MICRO	IP54-65	two-way

3-way ball valve with electrical actuator ON-OFF with T-port (S4051 230V - S4061 24V) or L-port (S4151 230V - S4161 24V).

ART. S.5070
BALL•O•MATIC 3 VIE / 3-WAY
PROPORZIONALE / PROPORTIONAL

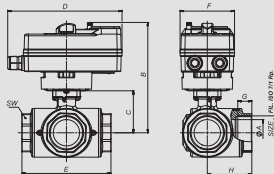

Size	1/4"	3/8"	1/2"	3/4"	1"	1 1/4"	1 1/2"	2"
øA	8	10	15	20	25	32	40	50
B	113	113	113	117	164,5	181	183,5	194
C	38	38	38	42	46,5	61	63,5	74
D	100	100	100	100	201	201	201	201
E	64,5	64,5	64,5	76	97	118	134,5	157
F	72,5	72,5	72,5	72,5	96	96	96	96
G	15	15	15	16,3	19,1	21,4	21,4	25,7
H	32,5	32,5	32,5	38	48,5	59	67,5	78,5
SW	25	25	25	31	38	55	55	67

CARATTERISTICHE ATTUATORE

S5070	con sfera a T	24V	0...10V	4...20mA	1 MICRO	IP54-65	bidirezionale
S5071	con sfera a L	24V	0...10V	4...20mA	1 MICRO	IP54-65	bidirezionale

Valvola a sfera a 3 vie con attuatore elettrico proporzionale con sfera a T (S5070) o a L (S5071).

FEATURES OF THE ACTUATOR

S5070	with T-port	24V	0...10V	4...20mA	1 MICRO	IP54-65	two-way
S5071	with L-port	24V	0...10V	4...20mA	1 MICRO	IP54-65	two-way

3-way ball valve with proportional actuator with T-port (S5070) or L-port (S5071).

ART. S.4301
BALL•O•MATIC 3 VIE / 3-WAY

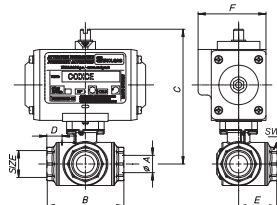

Size	1/4"	3/8"	1/2"	3/4"	1"	1 1/4"	1 1/2"	2"
øA	8	10	15	20	25	32	40	50
B	64,5	64,5	64,5	76	97	118	134,5	157
C	129	129	129	133	137,5	172,5	174,5	185
D	15	15	15	15	16,3	19,1	21,4	25,7
E	32,5	32,5	32,5	38	48,5	59	67,5	78,5
F	67	67	67	67	67	85	85	85
SW	25	25	25	31	38	47	55	68

CARATTERISTICHE ATTUATORE

S4301	con sfera a T	Tecnopolimero	doppio effetto
S4311	con sfera a L	Tecnopolimero	doppio effetto
S4321	con sfera a T	Tecnopolimero	singolo effetto
S4331	con sfera a L	Tecnopolimero	singolo effetto

Valvola a sfera a 3 vie con attuatore pneumatico in tecnopolimero.

FEATURES OF THE ACTUATOR

S4301	with T-port	Technopolymer	double acting
S4311	with L-port	Technopolymer	double acting
S4321	with T-port	Technopolymer	single acting
S4331	with L-port	Technopolymer	single acting

3-way ball valve with pneumatic actuator in technopolymer.

ART. S.4401
BALL•O•MATIC 3 VIE / 3-WAY

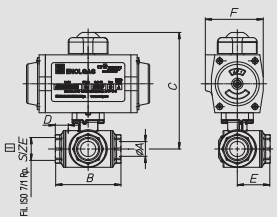

Size	1/4"	3/8"	1/2"	3/4"	1"	1 1/4"	1 1/2"	2"
øA	8	10	15	20	25	32	40	50
B	64,5	64,5	64,5	76	97	118	134,5	157
C	125	125	125	129	133,5	164,25	166,5	177
D	15	15	15	15	16,3	19,1	21,4	25,7
E	32,5	32,5	32,5	38	48,5	59	67,5	78,5
F	60	60	60	60	60	73	73	73
SW	25	25	25	31	38	47	55	68

CARATTERISTICHE ATTUATORE

S4401	con sfera a T	Alluminio	doppio effetto
S4411	con sfera a L	Alluminio	doppio effetto
S4421	con sfera a T	Alluminio	singolo effetto
S4431	con sfera a L	Alluminio	singolo effetto

Valvola a sfera a 3 vie con attuatore pneumatico in alluminio.

FEATURES OF THE ACTUATOR

S4401	with T-port	Aluminium	double acting
S4411	with L-port	Aluminium	double acting
S4421	with T-port	Aluminium	single acting
S4431	with L-port	Aluminium	single acting

3-way ball valve with pneumatic actuator in aluminium.