

BASIC • HT

Ball valve for overheated water

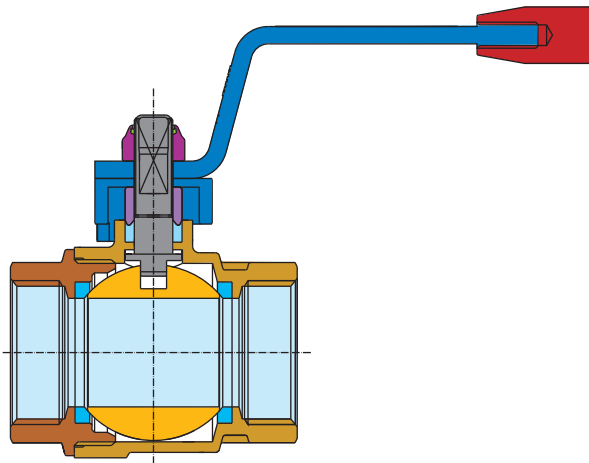

- BODY 1
- END ADAPTER 2
- BALL 3
- BALL GASKETS 4
- STEM 5
- THRUST WASHER 6
- STEM PACKING 7
- NUT 8
- LEVER WITH TEMPERATURE INDICATOR 9
- SELF-LOCKING NUT 10

MATERIAL SPECIFICATION

COMPONENT	MATERIAL	DESCRIPTION
1 Body	CW 617 N UNI EN 12165	Nickel-plated, forged brass
2 End adapter	CW 617 N UNI EN 12165	Nickel-plated, forged brass
3 Ball plated	CW 614 N UNI EN 12164	Machined brass bar, chrome-plated
4 Ball gaskets	P.T.F.E.	Pure Teflon
5 Stem	CW 614 N UNI EN 12164	Machined brass bar, nickel-plated
6 Thrust washer	P.T.F.E. FILLED	
7 Stem packing	P.T.F.E. FILLED	
8 Nut	CW 614 N UNI EN 12164	Machined brass bar
9 Lever handle	Zinc-plated steel	Zinc-plated
10 Self-locking nut	Zinc-plated 8G steel	Zinc-plated

Double seal blow out-proof stem

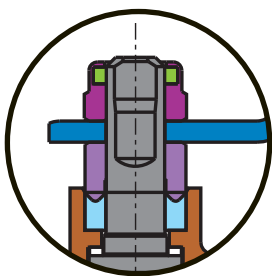

The **BASIC•HT** ball valves are bottom loaded stem designed. This "anti-blow-out" stem offers more guarantees against the accidental release of the stem and it prevents from tampering with the internals of the valve.

The double seal is performed by an anti-friction Teflon thrust washer, working as a high pressure gasket

THREADS

Screwed to ISO 228/1 standard.

USES

The **BASIC•HT** valves are suitable for use with overheated water.

Moreover they are suitable for use with hot and cold water, compressed air, oils and hydrocarbons in general.

For special uses please refer to the table of chemical resistance.

TEMPERATURE LIMITS

From - 20°C to + 170°C.

See pressure/temperature diagram.

Pressure/temperature diagram

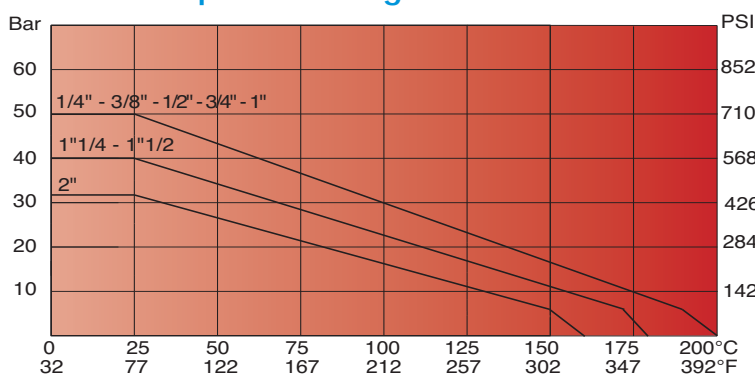

Head loss diagram

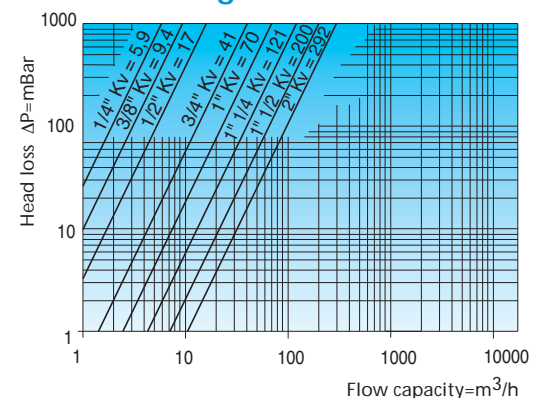

BASIC • HT

Ball valve for overheated water

Art. S.3084 BASIC•HT

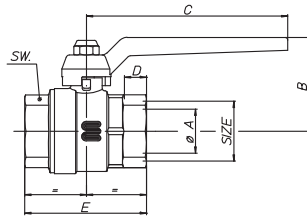

Full bore ball valve for **high temperature**, with aluminium lever handle, female/female, nickel-plated.

SIZE	¾"	½"	¾"	1"	1¼"	1½"	2"			
øA pass.	10	15	20	25	32	40	50			
B mm	38,5	40	49,5	53,5	64	74,5	90			
C mm	80	80	115	115	130	150	170			
D mm	11,4	9,5	11	12,5	13,5	15,5	17,5			
E mm	49,5	49	59	70	81	94	112			
SW mm	21	25	31	38	47	54	66			
Weight gr.	135	163	284	448	758	1300	2173			

Art. S.3085 BASIC•HT

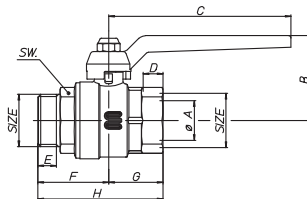

Full bore ball valve for **high temperature**, with aluminium lever handle, male/female, nickel-plated.

SIZE	½"	¾"	1"	1¼"	1½"	2"			
øA pass.	15	20	25	32	40	50			
B mm	40	49,5	53,5	64	74,5	90			
C mm	80	115	115	130	150	170			
D mm	9,5	11	12,5	13,5	15,5	17,5			
E mm	9,7	10,7	11,7	13,2	14,7	16,7			
F mm	35	40,5	44,4	51	57	66			
G mm	24,5	29,5	35	40,5	47	56			
H mm	59,5	70	79,5	91,5	104	122			
SW mm	25	31	38	47	54	66			
Weight gr.	192	330	530	864	1408	2259			

Art. S.1301 BASIC•HT

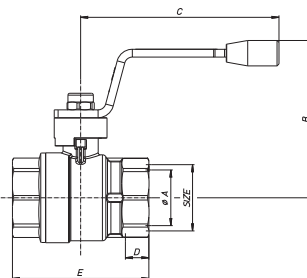

Full bore ball valve for **high temperature**, with aluminium lever with temperature indicator, female/female, nickel-plated.

SIZE	¾"	1"						
øA pass.	20	25						
B mm	74	81						
C mm	102	102						
D mm	12,5	13,5						
E mm	70	81						
SW mm	31	38						

Art. S.1302 BASIC•HT

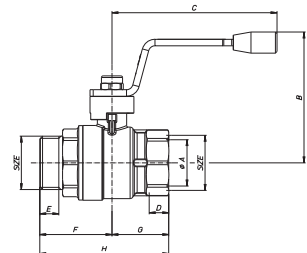

Full bore ball valve for **high temperature**, with aluminium lever handle with temperature indicator, male/female, nickel-plated.

SIZE	¾"	1"						
øA pass.	20	25						
B mm	74	81						
C mm	102	102						
D mm	12,5	13,5						
E mm	11,7	13,2						
F mm	44,5	51						
G mm	35	40,5						
H mm	79,5	91,5						
SW mm	31	38						